



Louisville, Kentucky - USA
November 28 - December 1, 2013

Sing'n'Joy

International Choral
Festival and Competition



INTERKULTUR EVENTS

2014

Registration Deadline:
OCT 31, 2013
Early Bird: SEP 15, 2013



**Canta en Primavera – Málaga 2014
Festival Coral Internacional**

**March 12 – 16, 2014
Málaga, Spain**

03

Registration Deadline:
NOV 30, 2013
Early Bird: SEP 30, 2013



13th Concorso Corale Internazionale

**April 13 – 17, 2014
Riva del Garda, Italy**

04

Registration Deadline:
DEC 15, 2013
Early Bird: SEP 30, 2013



**12th International Choir
Competition & Festival Bad Ischl**

**April 30 – May 4, 2014
Bad Ischl, Austria**

04

Registration Deadline:
MAR 1, 2013



Singalong Concert International

**May 15 – 18, 2014
Budapest, Hungary**

05

Registration Deadline:
JAN 31, 2014
Early Bird: OCT 31, 2013



**Sing'n'Joy Vienna 2014
29th International Franz Schubert
Choir Competition & Festival**

**June 5 – 9, 2014
Vienna, Austria**

06



Registration Deadline:
DEC 1, 2013
Early Bird: SEP 15, 2013



8th World Choir Games

**July 9 – 19, 2014
Riga, Latvia**

RIGA 2014
A EUROPEAN CAPITAL
OF CULTURE EVENT

Registration Deadline:
APR 15, 2014
Early Bird: JAN 31, 2014



**7th International Robert Schumann
Choir Competition**

**October 15 – 19, 2014
Zwickau, Germany**

10

Registration Deadline:
MAY 31, 2014
Early Bird: MAR 15, 2014



**CANTA AL MAR
3rd Festival Coral Internacional**

**October 22 – 26, 2014
Caella & Barcelona, Spain**

10

Registration Deadline:
SEPT 5, 2014
Early Bird: JUN 16, 2014



**Sing'n'Joy Louisville, Kentucky, USA
International Choral Festival &
Competition**

**November 27 – 30, 2014
Louisville Kentucky (US A)**

11

Photo Credits: © Sean Hughes



**INTERNATIONAL CHORAL
FESTIVAL AND COMPETITION**
LOUISVILLE, KENTUCKY USA

Sing'n'Joy
Louisville, Kentucky USA
International Choral Festival & Competition
November 28 – December 1, 2013

Organizers
INTERKULTUR
GALT HOUSE HOTEL

Günter Titsch, President, INTERKULTUR
Mary Moseley, President, Galt House Hotel

INTERKULTUR Artistic Committee
Christian Ljunggren, Artistic Director (Sweden)
Dr. Kent Hatteberg, University of Louisville, Artistic Director (U.S.A.)
M. Kim Mann – Artistic Coordinator North America (U.S.A.)

CREATING UNFORGETTABLE ARTISTIC MOMENTS

The artisans of the Louisville Stoneware Art Factory are pleased to present this handcrafted, one-of-a-kind Fleur De Lis award to the winners of the Sing 'n' Joy International Choral Festival and Competition.



Since 1815, the Louisville Stoneware Art Factory has maintained an uncompromising dedication to quality, community and environmental sustainability. Today Stoneware continues to use centuries-old ceramics techniques – of earth, water, air and fire – creating art in its Paristown Pointe factory in Louisville, Kentucky.

STONEWARE

est. 1815

Retail Showroom • Paint Your Own Pottery • Monday - Saturday

Art Factory Tours • Monday - Friday

Custom and Corporate Gifts • Bridal Registry

731 Brent Street Louisville, KY 40204 • 502.582.1900

www.LouisvilleStoneware.com



Table of Contents

	Page
Greetings from Günter Titsch	6
About INTERKULTUR	7
Greetings from Louisville	9
Artistic Committee and Jury Members	10-13
Key to Event Participation Categories	14
Official Host Venues & Schedule of Events	15-21
Map of Galt House Hotel SUITE Tower Second Floor	22
Map of Sing'n'Joy Performance Venues	23
Participating Choirs	24-33



EVENT PRODUCTION TEAM

INTERKULTUR

Lori Lobsiger
Director North American Markets

Kim Mann
U.S. Artistic Coordinator Chorus Operations

Jelena Dannhauer
International Project Manager (Germany)

Elisabeth Stockmann
Touristic Manager (Germany)

Danielle Meiners
Assistant to the Director & Chorus Operations

Nancy Riley
U.S. Project Coordinator

Event Staff

Jan Besl	Ti Mikkell
Hope Hatteberg	Joy Riley
Sarah Hatteberg	Cindy Schrader
Jordan Lobsiger	Chris Shortt

Interkultur Videography
Palmer Durr

GALT HOUSE HOTEL

Terry Jenks
General Manager

Lisa S. Haller
Executive Director of Sales & Marketing

Rita Stephenson Reedy
Corporate Marketing Director

Galt House Sing'n'Joy Staff:

Dee Asher
Sales Manager

Ashley Brauer
Marketing Communications Manager

Courtney Glenny
Entertainment and Attractions Coordinator

Kelly J. Gream
Marketing Manager

Holly Keenen
Manager, Attractions and Entertainment



Günter Titsch

President, INTERKULTUR

Dear Friends and Singers,

It is a pleasure to welcome you to this premiere Sing'n'Joy event in Louisville, Kentucky USA! We are pleased to have the historic Galt House Hotel organization as our partner and host hotelier for choirs and friends. What a tremendous way to kick-off the holiday season with the KaLightoscope lantern displays, a holiday parade, the lighting of Louisville and the joy of singing!

Since 1988 INTERKULTUR has been producing and ever improving international choral festivals and competitions that promote *"singing together"* for choirs and their esteemed conductors.

Today, INTERKULTUR organizes events in Austria, China, Germany, Hungary, Italy, Indonesia, Latvia, Malta, Spain, Vietnam and the United States...to name a few! The culmination is our biannual event, the World Choir Games that took place in Cincinnati last year and will be organized by our Latvian colleagues in the beautiful city of Riga next summer. Our events invite choirs of all artistic levels to participate. We award competition participants from the Musica Mundi adjudication evaluation system which recognizes and awards for the individual artistic best of each choir and celebrates and encourages that "participation is the highest honor".

We are so proud that Louisville USA has joined our family of prestigious host cities and we look forward to a long tradition of singing in Louisville!

Wishing you and yours, the most joyous holiday season!

A handwritten signature in black ink, appearing to read 'Günter Titsch', written in a cursive style.

Günter Titsch
President, INTERKULTUR
World Choir Games



...Connecting Bridges

The first INTERKULTUR International Choir Competition in Budapest, held in 1988, was the start of one of the largest and most successful series of cultural events in Europe. The INTERKULTUR Event Series has become known throughout the world for high artistic and organizational standards and as an opportunity for choirs and choir enthusiasts worldwide.

INTERKULTUR's founding vision was to bring an Olympic ideal to the choral community. The Choir Olympics 2000 in Linz, Austria was the beginning of a world choir games concept that led to subsequent events in Busan, Republic of Korea in 2002, and Bremen, Germany in 2004. This success continued as the "World Choir Games" in Xiamen, China in 2006, Graz, Austria in 2008, Shaoxing, China in 2010, and Cincinnati, USA in 2012. In 2014, the World Choir Games will be held in Riga, Latvia.

Another milestone in the history of INTERKULTUR was to establish a continent-based championship for choirs. The first World Choir Championships debuted in 2009 in the Province of Gyeongnam, Republic of Korea, followed by the World Choir Championships for Youth and Young Adults in Graz, Austria in 2011. Graz again served as host for the first European Choir Games and the "Songs of Spirit Festival" in 2013.

The Idea

INTERKULTUR has become synonymous for a unique artistic concept in producing choral competitions and festivals. Historically, international choir competitions have only invited the most elite choirs to participate. INTERKULTUR competitions are open to all non-professional choirs, regardless of their artistic experience. INTERKULTUR has opened a door to new opportunities of cultural exchange for the international choral movement.

The Quality Seal

Musica Mundi® is the exclusive quality seal on all INTERKULTUR events and festivals worldwide. This seal ensures common judging standards across all events, and allows competition at various levels of difficulty with or without compulsory pieces in a wide range of categories. Choirs are evaluated in both Technical and Artistic elements including intonation, sound quality, fidelity to the score, (in some categories interpretation practice or authenticity) and overall artistic impression. An expert international jury consists of choral conductors, music educators, and music professionals.

The Competitions

The essence of the Musica Mundi® concept allows all choirs to participate in competitions alongside the top choirs of the world. Open Competition or qualifying competition is for any choir, regardless of artistic achievement, wishing to participate. The Champions Competition or categories of advanced difficulty with compulsory pieces are for choirs that have already proven their ability in international concerts and choral competitions.

Evaluation System

Choirs may receive gold, silver, or bronze awards depending on the number of points awarded by the jury according to the Musica Mundi® evaluation system.

The Participants

In total, more than 6,800 choirs with roughly 300,000 active singers from 100 countries have taken part in the INTERKULTUR competitions to date.

European Culture Award

INTERKULTUR was awarded the 2006 European Culture Award, by former German Minister of Foreign Affairs, Hans Dietrich Genscher and presented by KulturForum Europa, for its activities on behalf of understanding between peoples and furtherance of common European thinking in the field of culture.

LOUISVILLE FACTOIDS

1 For nearly 140 years, the world has turned to Churchill Downs the **first Saturday in May**, for the first leg of the Triple Crown of Thoroughbred racing, the Kentucky Derby.

2 **Babe Ruth, Ty Cobb, Mickey Mantle, Hank Aaron** and **Johnny Bench** are just a few of the baseball legends who have used the Hillerich & Bradsby Company's Louisville Slugger.

3 The **Belle of Louisville** is the oldest operating Mississippi-style stern wheeler steamboat in existence today. She will celebrate her 100th birthday in 2014.

4 Louisville's Historic Main Street has the nation's second **largest collection of cast-iron** storefront facades. Only New York City has more.

5 Old Louisville is home to the **largest collection of Victorian Mansions** in the United States.

6 Louisville is the location for the **busiest canal in the world**. More tonnage passes through the McAlpine Locks and Dam System on the Ohio River than the Panama Canal and Suez Canal combined.

7 Louisville is the world's center for Braille printing. The **American Printing House for the Blind** is the oldest national non-profit agency for the visually impaired in the U.S., and the nation's largest publisher of literary aids for the blind.

8 Known as the **"city of parks,"** metro Louisville has 122 parks, covering nearly 12,500 acres.

9 **Louisville International Airport** is the third busiest air cargo facility in North America and the 10th busiest in the world.

10 The population of the metro Louisville area is **1.3 million**.

11 The **Mint Julep** is revered as Louisville's cocktail of choice each year as the official drink of the Kentucky Derby. It's a powerful concoction of sugar, water, crushed ice, bourbon and mint.

12 **Modjeska**, a candy treat, originated in Louisville by candy maker Anton Busath. This specially made marshmallow dipped in liquid caramel was named in honor of famed Polish actress Helena Modjeska after Busath saw her perform a play in Louisville.

13 When you order "whiskey" in Louisville you usually get **bourbon** – 95% of all bourbon is made in Kentucky.

14 Louisville has been named as one of the **"best foodie getaways in the world"** by Zagat.



SOURCE: Louisville Convention & Visitors Bureau



SPECIAL MESSAGE FROM MAYOR GREG FISCHER

Greetings, and welcome to Louisville!

We are thrilled to welcome the many schools, churches and choral groups that are joining their voices and helping make Louisville a more festive and inspirational place during the Sing 'n' Joy International Choral Festival and Competition. Your talents will beautifully complement the holiday atmosphere that families enjoy with the Christmas at The Galt House Hotel, and our downtown Light Up Louisville, and Forty Nights of Lights Celebration.

While you're here, we will do everything possible to make you feel at home. You will find that we are a friendly and vibrant city offering top-notch facilities, one-of-a-kind attractions, great food and lots of places to have fun. I hope that outside of your performances and competition you'll have time to sample at least some of what our city has to offer – our great performing arts, parks, restaurants and downtown museums and attractions including the Frazier History Museum, Muhammad Ali Center, and the Louisville Slugger Museum and Factory.

Best of luck with your competition! I hope you have an exciting and enjoyable event and a wonderful holiday season.

Sincerely,
Greg Fischer, Mayor



SPECIAL MESSAGE FROM MARY MOSELEY

Dear Sing 'n' Joy Participants:

It is my pleasure to welcome you to the Galt House Hotel and Louisville, Kentucky with open arms and warm hearts. We are so excited to experience the cultures and traditions of people from around the globe, as well to see the passion each choir and its members exude during the Sing 'n' Joy International Choral Event. We are proud to host this first-of-its-kind in the Americas choral competition in partnership with INTERKULTER Americas. As we welcome you into our home, we wish you the best in your performances and hope you enjoy our fine city.

Sincerely,
Mary Moseley
President & CEO, Galt House Hotel

Artistic Committee



Christian Ljunggren

*Artistic Director
INTERKULTUR
(Sweden)*

Christian Ljunggren studied music at the Royal Academy of Music in Stockholm as well as musicology and theology at the University of Uppsala. For many years he worked at the Music Department of the Swedish National Broadcasting Company, responsible for presentation and programs on music. He founded and is conductor of two choirs: the Adolf Fredrik Madrigal Choir formed in 1965, and the Nicolai Chamber Choir formed in 1974. With his choirs he has made concert tours throughout Europe, USA, Canada, Venezuela, Argentina, South Africa and China. He is past Secretary General of IFCM, the International Federation for Choral Music. He has been an Artistic Director of INTERKULTUR since 2002.

M. Kim Mann holds graduate degrees of distinction in choral/vocal music with a Master of Science in Education from Indiana University. Her areas of concentration include children's and youth chorus, madrigal, show choir, and vocal arts performance. During her career, Kim has taught and conducted in the Indiana and Ohio public school systems. She serves on the faculty of Chatfield College, Broadway Bound Academy, Cincinnati State College, teaches private voice and contest preparation, and has been musical director to the First Presbyterian Church, USA, and artistic director of Pizzazz School of Performing Arts. Kim was U.S. Artistic Coordinator for the 2012 World Choir Games in Cincinnati, Ohio.



M. Kim Mann

*U.S. Artistic Coordinator
Chorus Operations*



Kent Hatteberg
U.S. Sing'n'Joy
Artistic Director

Dr. Kent Hatteberg is Director of Choral Activities at the University of Louisville, where he directs the Collegiate Chorale and Cardinal Singers, administrates the graduate program in choral conducting, and teaches graduate and undergraduate courses in conducting, choral literature, and choral techniques. He earned the bachelor's degree in piano and voice *summa cum laude* from the University of Dubuque and the master's and doctoral degrees in choral conducting from The University of Iowa. Under his direction, the University of Louisville Cardinal Singers have performed in numerous international competitions, festivals, and symposiums, and have been consistently ranked as a top choir in the INTERKULTUR World Rankings.

***Leonard Bernstein's
Chichester Psalms***

Conducted by Dr. Kent Hatteberg



© Sean Hughes

Leonard Bernstein received a commission in 1965 from Walter Hussey, Dean of Chichester Cathedral, and John Birch, organist at the cathedral, to compose a work for the 1965 Southern Cathedrals Festival at Chichester Cathedral in the county of Sussex, England. The outcome of that commission was his *Chichester Psalms*, a three-movement work scored for boy solo, chorus, strings, three trumpets, three trombones, two harps, and a large percussion section. Bernstein chose texts in the original Hebrew language from psalms 108, 100, 23, 2, 131, and 133. He conducted the premiere of the work with the New York Philharmonic in New York in July 1965, and Mr. Birch conducted it later that month in England. It has since become one of Bernstein's most often-performed works.

Chichester Psalms is an eclectic work featuring elements of American jazz, pop music, and musical theatre. Bernstein juxtaposes the use of lively rhythms and non-symmetric time signatures highlighted by a battery of percussion instruments with a relatively tame harmonic structure, his gift for writing a simple melody, and moments of remarkable serenity, creating a work of immense beauty and effect.

A Festival Stage Choir performance of *Chichester Psalms* will be conducted by Dr. Kent Hatteberg in the Closing Ceremony Concert December 1st at 3:00pm in Kentucky Center's Whitney Hall. For tickets: (800) 775-7777

Jury Members



William Caldwell, Jury Member

William Henry Caldwell is a retired professor and choral director Emeritus of Central State University. He served as chairman of Fine and Performing Arts and conductor of the Grammy nominated Central State University Chorus for 34 years. He holds degrees from Stillman College and the University of Texas in Austin. He also studied at Ohio State University and the University of Cincinnati - College Conservatory of Music and in Lucca, Italy. Caldwell has toured extensively throughout the United States, Europe, and Asia during his tenure as conductor and has appeared as a lyric baritone soloist with numerous Ohio orchestras.

William Caldwell will present a workshop - The African American Spiritual: Songs of Life and Death



Joe Cerutti, Jury Member

Joe Cerutti holds a M.M. in Choral Conducting from Boston University where he studied with Howard Jones, Jamison Marvin and Joe Flummerfelt. Cerutti is a conductor, music director, clinician and adjudicator. He is the music director of the Alexandria Harmonizers, Pride of Baltimore and the No Borders Youth Chorus. He is a member of B.H.S, a charter member of NCCO, and a member of ACDA, MENC, and Chorus America. He is a certified music judge in the BHS and the youngest of nine men to be named "Master Director" in BHS history. Cerutti served as an adjudicator for the 2012 World Choir Games.

Joe Cerutti will present a workshop - Under the Barbershop

Umbrella: Just about any song from any genre can be arranged and performed in the barbershop style!



Dr. Mary Goetze, Jury Member

Dr. Mary Goetze **Mary Goetze** was instrumental in founding the "Music in General Studies" program during her tenure at the Indiana University Jacobs School of Music. She founded two choral programs that continue today - the International Vocal Ensemble & the Indiana University Children's Choir. Goetze is Professor Emerita at I. U. and continues to compose for choruses, author articles and books, and travel as lecturer, workshop clinician and conductor for international honor choirs. Goetze served as an adjudicator for the 2012 World Choir Games.

Mary Goetze will present a workshop - Singing *THEIR*Way: Exploring the Music of Diverse Musical Cultures with Bel Canto-Trained Singers

Lalene Kay, Jury Member

Lalene Kay is a Board Certified Music Therapist as well as a Certified Activity Consultant. She is a Music Therapy Consultant for Fairview Hospital, Cleveland Clinic, Adult Day Care Center and State Board member of the Ohio Music Educators association as a Special Learners Chair. She will be an adjudicator and advisor for the Alternative Learners category which will debut during Sing'n'Joy Louisville 2013.

Lalene Kay will be presenting a workshop - Alternative Learners: Modify your standards, don't lower them!



Johan Rooze, Jury Member (South Korea)

Johan Rooze is a lecturer, clinician, conductor, pianist, and arranger originally from the Netherlands, now residing in South Korea. He is a full-time professor at Hangeuk University of Foreign Studies in Seoul where he teaches Dutch and conducts jazz choir, the "Yaenoel Jazz Singers" and a professional students choir, the "Daegu Students Choir". In the Netherlands, he conducted the Vocal Jazz group "Dekoor" from the University of Utrecht and was highly awarded at international festivals. Rooze was also the conductor and artistic director of the Symphonic Choir and Orchestra of the Utrecht University (UKSO) and former professor for choral conducting at the Conservatory of Alkmaar and Vocal Jazz at the Conservatory of Rotterdam in the Netherlands. Rooze served as an adjudicator for the 2012 World Choir Games.

Johan Rooze will present a workshop - Holiday Pop'n'Jazz! Sing and enjoy famous holiday songs re-arranged to swing and rock your way through the season



Aida Swenson, Jury Member (Indonesia)

Aida Swenson is a highly regarded choral conductor in Indonesia and is one of the region's strongest forces of choral music development. The Indonesian Children and Youth Choirs *Cordana* have gathered international recognition and awards under her direction as founder and conductor. They have performed in major cities in the United States, Germany, Poland, Japan, Philippines, Singapore, Denmark, France, Canada, Argentina and other Asian countries. As a graduate of the Westminster Choir College, USA, Aida received her degree with a scholarship from the World Council of Churches. Swenson served as an adjudicator for the 2012 World Choir Games.

Aida Swenson will present a workshop - Indonesian Choral Music: How Indonesian choral music reflects multi-cultural influences from the Christian, Muslim, & Buddhist traditions and incorporates traditional dance and movement



Categories of Participation

Sing'n'Joy provides choirs the opportunity to customize their event experience by choosing from a selection of competitive and non-competitive participation opportunities. This key explains the codes appearing throughout the Schedule of Events.

NON-COMPETITIVE PARTICIPATION	
ALFSC	Alternative Learners Festival Stage Choir
FC	Friendship Concert
FSC	Festival Stage Choir
CATEGORIES OF COMPETITION	
A1	Mixed Choirs, Difficulty Level I
A2	Male Choirs, Difficulty Level I
A3	Female Choirs, Difficulty Level I
AL	Choirs of Alternative Learners
B1	Mixed Choirs, Difficulty Level II
B2	Male Choirs, Difficulty Level II
B3	Female Choirs, Difficulty Level II
BB1	Barbershop Choruses
BB2	Barbershop Quartets
G1	Children's Choirs (S(S)A(A) 6-16 years old)
G2	Youth Choirs of Equal Voices (Boys & Girls S(S)A(A) 12-21, Boys T(T)B(B) 14-24 years old)
G3	Youth Choirs of Mixed Voices (SA(T)B 8-24 years old)
P	Pop - Gospel - Jazz
SP	Spiritual

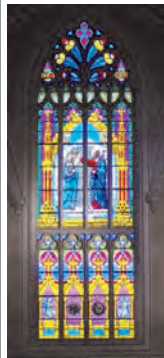

© Anna Bentley

Official Host Venues

The Organizers are grateful to these fine quality venues for hosting the concerts and competitions of Sing'n'Joy 2013.

- ● ● ● **Galt House Hotel**
140 N. Fourth Street
- **KaLightoscope Christmas**
Next to Galt House Hotel RIVUE Tower
- **Cathedral of the Assumption**
433 S. Fifth Street
- **Kentucky Center for the Performing Arts - Whitney Hall**
501 W. Main Street
- **Muhammad Ali Center**
144 N. 6th Street
- **Louisville Slugger Museum & Factory**
800 W. Main Street
- **Churchill Downs**
700 Central Avenue [40208]

- Welcome & Opening, Choir Lounge, Official Hotelier
- Competition
- Workshops
- Friendship Concert
- Celebration Concert, Awards & Closing Concert

Reference Map Pages 22-23

Schedule of Events

Times subject to change

Thursday, November 28, 2013

TIME	EVENT	LOCATION
11:30am-1:00pm	Friendship Concert at Churchill Downs	Gate 17
	Coro San Benildo Chorale	

Happy Thanksgiving!

Friday, November 29, 2013

TIME	EVENT	LOCATION
10:00am-8:00pm	Visit KaLightoscope Christmas	
10:30am-11:30am	Workshop: Indonesian Choral Music <i>Clinician: Aida Swenson</i>	Galt House Ballroom A
11:45am-12:45pm	Alternative Learners Festival Stage Choir <i>Open Rehearsal with Terri McCoy</i>	Galt House Ballroom A
11:45am-12:45pm	Workshop: Singing THEIR Way: Explore Music of Diverse Cultures with Bel Canto Trained Singers <i>Clinician: Mary Goetze</i>	Galt House Caroll Ford
12:00pm-1:30pm	Friendship Concert at the Muhammad Ali Center Lafayette High School Madrigal Singers Little Miami Select Women's Chorale Youth Performing Arts School Chamber Choir Seattle Children's Choir - Arioso	
1:00pm-2:00pm	Workshop: Let Their Song Be Heard: Music as a Tool For Success with Special Needs Students <i>Clinician: Terri McCoy</i> <i>Featuring: To The Nines, demonstration choir</i>	Galt House Ballroom A
1:30pm-3:30pm	Competition	Cathedral of the Assumption
	Category B3: Female Choirs, Difficulty Level II	
	Sound of Joy Conductor: Xi Wang	
	<ul style="list-style-type: none"> · <i>Dance of Youth</i> Luobin Wang · <i>Riding on a Mule</i> Arr. Yi Chen · <i>The Moon Represents My Heart</i> Ching-hsi Weng 	
	Category A1: Mixed Choirs, Difficulty Level I	
	Ball State University Singers Conductor: Dr. Alan Alder	
	<ul style="list-style-type: none"> · <i>Lovesight</i> R. Young/D. G. Rossetti · <i>Things That Never Die</i> C. Dickens/L. Dengler · <i>Mata del anima sola</i> A. Torrealba/ A. Estévez · <i>Rockin' Jerusalem</i> André J. Thomas 	
	Georgia Southern Chorale Conductor: Dr. Shannon Jeffreys	
	<ul style="list-style-type: none"> · <i>Song of Triumph</i> Dale Grotenhuis · <i>Psalm 150 in Grandsire Triples</i> Jaakko Mäntyjärvi · <i>Dwijavanthi</i> Ethan Sperry · <i>Sakkijarven Polkka</i> Arr. Jonathan Rathbone 	

Friday, November 29, 2013 *[continued]*

TIME	EVENT	LOCATION
	Competition <i>[Continued]</i>	Cathedral of the Assumption
	Coro San Benildo Conductor: Lorenzo C. Gealogo · <i>Dumbele</i> · <i>The Prayer</i> · <i>Eres tu</i> · <i>Daemon irrepit callidus</i>	Rodolfo Delarmente D. Foster, Arr R. Delgado Robert Delgado György Orbán
	Competition Intermission	
	Category SP: Spiritual	
	Georgia Southern Chorale Conductor: Dr. Shannon Jeffreys · <i>By and By</i> · <i>Deep River</i> · <i>Ride on King Jesus</i>	Arr. Carol Barnett Arr. Norman Luboff Arr. Edward Boatner
	Seattle Children's Choir - Arioso Conductor: Krista Mason · <i>Little Boy</i> · <i>I'm Goin' Home On A Cloud</i> · <i>Steal Away</i>	Arr. Robert DeCormier Arr. Susan Taylor-Howard Arr. Robert Nelson
2:15pm-3:45pm	Festival Stage Choir Open Rehearsal <i>Conducted by Dr. Kent Hatteberg</i>	Galt House Ballroom A
2:45pm-3:45pm	Workshop: The Magic of Energy: Achieving Showmanship in Performance <i>Clinician: Betty Lou Coleman</i>	Galt House Caroll Ford
4:00pm-5:00pm	Workshop: The African American Spiritual: Songs of Life and Death <i>Clinician: William Caldwell</i>	Galt House Ballroom A
5:00pm	Galt House Dancing Bellmen Performance	Galt House SUITE Lobby
6:30pm 8:00pm	Light Up Louisville Parade & Main Stage Parade steps off at 4th & Liberty St, and concludes at 4th & Main. Louisville Cardinal Singers perform on the Main Stage.	
8:30pm-10:00pm	Welcome & Opening Keynote Address Galt House Ballroom A	
	<ul style="list-style-type: none"> · Choirs come together to kick off Sing'n'Joy with Cookies & Cocoa and a special welcome performance by the Ball State University Singers. · "I Am Potential!" Keynote Speaker Patrick Henry Hughes has inspired and motivated millions around the world to reach their full potential. 	

Saturday, November 30, 2013

TIME	EVENT	LOCATION
9:45am-10:45am	Alternative Learners Festival Stage Choir <i>Open Rehearsal with Terri McCoy</i>	Galt House Ballroom A

10:00am-8:00pm **Visit KaLightoscope Christmas**
Including spontaneous singing throughout the day!

10:00am-1:00pm **Competition** Cathedral of the Assumption

Category BB2: Barbershop Quartets

Forefront

- *Put Your Arms Around Me, Honey* McCree/Tilzer, Arr. R. Hopkins
- *If You Love Me, Really Love Me* Piaf/Monnot, Arr. D. Wright
- *Seven Bridges Road* Steve Young, Arr. J. Johnson
- *Alleluia* Gatlin, Arr. E. Wright/J. Henry

Category BB1: Barbershop Choruses

Pride of Kentucky Chorus

Conductor: Debbie Hite

- *t's A Brand New Day* Bob "Diz" Disney
- *Lazy Day* Powers/Fischhoff, Arr. D. Wright
- *If Ever I Would Leave You* Loewe/Lerner, Arr. C. Hine
- *Smile Medley* Meskill/O'Flynn/Rich/Lombardo
Rochinski, Arr. C. Hine

Thoroughbred Chorus

Conductor: Andrew Wheaton

- *There's No Business Like Show Business* Berlin, Arr. Arberg
- *Always* Berlin, Arr. M. Hale/D. Gray
- *You're Nobody 'Til Somebody Loves You* Arr. Clay Hine
- *A Special Night* Don Besig
- *Go Tell t On The Mountain* Roger Payne, Arr. ROG

Category G3: Youth Choirs of Mixed Voices

Eastern High School Chorale

Conductor: Lori Knapke

- *Bogoróditse Djévo* Arvo Pärt
- *Northern Lights* Ola Gjeilo
- *Nachtwache II (Opus 104, No. 2)* Johannes Brahms

Lafayette High School Madrigal Singers

Conductor: Ryan Marsh

- *Sechs Sprüche op. 79, No. 1 & 5* Felix Mendelssohn
- *O Nata Lux* Guy Forbes
- *Noél Ayisyen (A Haitian Noël)* Emile Desamours

Saturday, November 30, 2013 *[continued]*

TIME	EVENT	LOCATION
	Competition <i>[Continued]</i>	Cathedral of the Assumption
	Competition Intermission	
	Youth Performing Arts School Chamber Choir Conductor: Jacob Cook · <i>Sing Joyfully</i> William Byrd · <i>Psalm 43 Richte mich, Gott.</i> F. Mendelssohn, ed. C. Fuller · <i>We Beheld Once Again the Stars</i> Z. Randall Stroope	
	Western Hills Advanced Chorale Conductor: Tiffany Marsh · <i>O Magnum Mysterium</i> Ivo Antognini · <i>Diffusa est gratia</i> Giovanni Maria Nanino · <i>Peze Kafé</i> Arr. Sten Källman	
	Category G2: Youth Choirs of Equal Voices	
	Little Miami Select Women's Chorale Conductor: Sarah J. Baker · <i>Little Lambs</i> Arr. Americ Goh · <i>No Time</i> Arr. Susan Brumfield · <i>Gaudete!</i> Piae Caniones, Arr. M. Engelhardt	
	Seattle Children's Choir - Arioso Conductor: Krista Mason · <i>Rise Up In Festive Song</i> Pierre Clereau · <i>Ave Maria</i> C. Saint-Saëns, Arr. J. Leininger · <i>Cantate Domino</i> Rupert Lang	
11:30am-12:00pm	Friendship Concert at the Louisville Slugger Museum Sound of Joy Choir	
12:00pm-1:00pm	Workshop: Harmony to the Forefront: Singing Tight Harmony With Today's Barbershop <i>Clinician: Andrew Wheaton</i> <i>Featuring: Forefront, demonstration quartet</i>	Galt House Caroll Ford
12:30pm-1:45pm	Festival Stage Choir Open Rehearsal <i>Conducted by Dr. Kent Hatteberg</i>	Galt House Ballroom A
1:15pm-2:15pm	Workshop: Under the Barbershop Umbrella: A Style of Performance & Arranging, Not Just a Genre <i>Clinician: Joe Cerutti</i>	Galt House Caroll Ford
2:30pm-3:30pm	Workshop: Holiday Pop 'n' Jazz! Swing & Rock in an Interactive Choral Sing-Fest <i>Clinician: Johan Rooze</i>	Galt House Caroll Ford

Saturday, November 30, 2013 *[continued]*

TIME	EVENT	LOCATION
4:00pm-5:00pm	Competition	Galt House Ballroom A
	Category P: Pop - Gospel - Jazz	
	Ball State University Singers Conductor: Dr. Alan Alder · <i>The Edge of Glory</i> <i>S. Germanotta/P. Blair/ F. Garibay, Arr. M. Brymer</i> · <i>I'd Give t All For You</i> Jason R. Brown · <i>Another Hundred People / The Morning After</i> S. Sondheim/R. Maltby/D. Shire	
	Little Miami Select Women's Chorale Conductor: Sarah J. Baker · <i>Más Que Nada</i> J. Ben, Arr. S. Zegree · <i>Embraceable You</i> Gershwins, Arr. K. Shaw · <i>Bridge Over Troubled Water</i> P. Simon, Arr. K. Shaw	
4:00pm-5:00pm	Workshop: Alternative Learners: Modify Your Standards, Don't Lower Them! <i>Clinician: Lalene Kay</i>	Galt House Caroll Ford
5:00pm	Galt House Dancing Bellmen Performance	Galt House Lobby SUITE Tower
5:15pm-6:15pm	Workshop: Showchoir: Making America's Modern Choral Genre Art <i>Clinician: Alan Alder</i> <i>Featuring: Ball State University Singers</i>	Galt House Ballroom A
6:30pm-7:30pm	Friendship Concert at the Galt House Hotel Ballroom A Pride of Kentucky To The Nines	
8:00pm-10:00pm	Celebration Concert Kentucky Center For Performing Arts - Whitney Hall Seattle Children's Choir - Arioso <i>Conducted by Krista Mason</i> Lafayette High School Madrigal Singers <i>Conducted by Ryan Marsh</i> Coro San Benildo <i>Conducted by Lorenzo C. Gealogo</i> Georgia Southern Chorale <i>Conducted by Dr. Shannon Jeffreys</i> Ball State University Singers <i>Conducted by Dr. Alan Alder</i> University of Louisville Cardinal Singers <i>Conducted by Dr. Kent Hatteberg</i>	

Sunday, December 1, 2013

TIME	EVENT	LOCATION
9:00am-10:30am	Competition	Galt House Ballroom A

Category AL: Choirs of Alternative Learners

To The Nines

Conductor: Terri McCoy

- *Operator* W. Spivery, Arr. K. Shaw
- *Carol of the Bells* P. Wilhousky/M. Leontovich, Arr. P. Wilhousky
- *A Charlie Brown Christmas* V. Guaraldi/L. Mendelson, Arr. S. Zegree

Melodic Connections

Conductor: Betsy Zenk Nuseibeh

- *Where is the Love* Adams/Pineda/Gomez/Board/Timberlake/Fratantuno/Pajon Jr./Curtis
- *Sittin' on the Dock of the Bay* S. Cropper & O. Redding
- *Home* G. Holden & D. Pearson

12:00pm-6:00pm

Visit KaLightscope Christmas

3:00pm

Awards Ceremony & Closing Concert

Kentucky Center For Performing Arts - Whitney Hall

Louisville Orchestra

Conducted by Jason Seber

Louisville Chamber Choir, Official Sing'n'Joy Host Choir

Conducted by Dr. Kent Hatteberg

Sing'n'Joy Jury Introduction

Festival Stage Chorus & Louisville Orchestra

Conducted by Dr. Kent Hatteberg

INTERMISSION (20 minutes)

Alternative Learners Festival Stage Chorus

Conducted by Terri McCoy

Sing'n'Joy Awards Presentation

Special Choral Performances by Jury Selection

Pop Sing-Along With Cardinal Singers, Official Sing'n'Joy Host Choir

Conducted by Dr. Kent Hatteberg



GALT HOUSE HOTEL SECOND FLOOR BALLROOM LEVEL SUITE TOWER

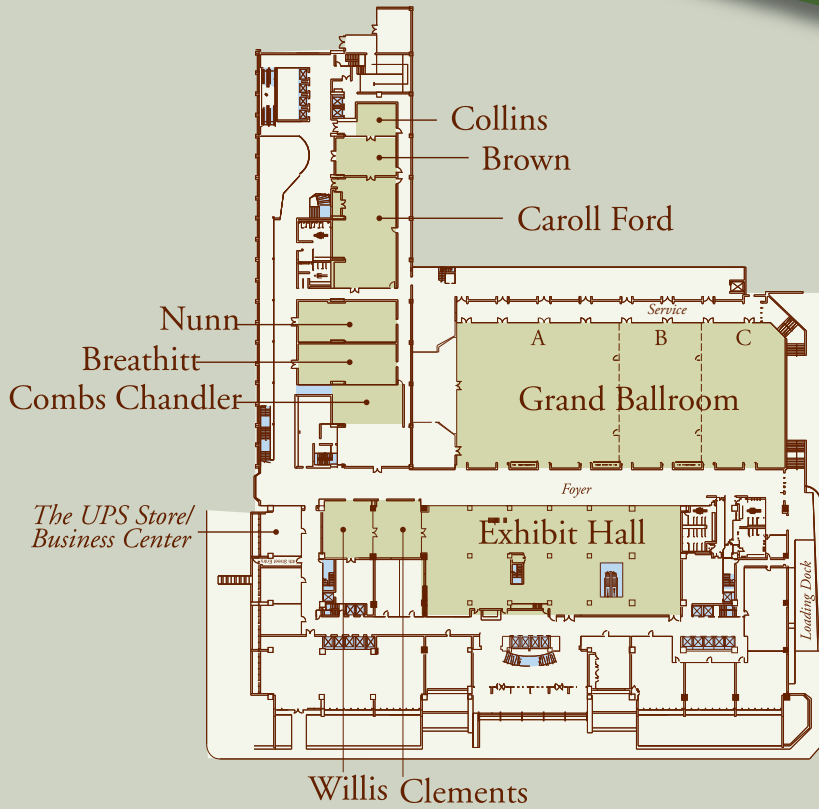

GALT HOUSE HOTEL
The Heart of Louisville

SING 'n' JOY PERFORMANCE VENUES



GALT HOUSE HOTEL
The Heart of Louisville

KEY:

- | | |
|---|--|
| 1. Galt House Hotel and the Light Up Louisville Stage | 8. Kentucky Museum of Art & Craft |
| 2. Kentucky Center for the Performing Arts | 9. Kentucky Science Center |
| 3. Muhammad Ali Center | 10. Frazier History Museum |
| 4. Louisville Slugger Museum & Factory | 11. Evan Williams Bourbon Experience |
| 5. Cathedral of the Assumption | 12. Flame Run Glass Studio and Gallery |
| 6. Churchill Downs | 13. Fourth Street Live! Entertainment District |
| 7. Belle of Louisville | 14. Big Four Bridge |
| | 15. NuLu Shopping District |
| | 16. KFC Yum! Center |

Participating Choirs



Ball State University Singers

Conductor: Dr. Alan Alder
Ball State, Indiana USA

Founded: 1964
A1, P



Cardinal Singers

Conductor: Dr. Kent Hatteberg
Louisville, Kentucky USA

Founded: 1970
FSC



Coro San Benildo

Conductor: Lorenzo C. Gealogo
Manila, Philippines

Founded: 1988
A1



Eastern High School Chorale

Conductor: Lori Knapke
Louisville, Kentucky USA

Founded: 1998
G3, FSC



Forefront

Louisville, Kentucky USA

Founded: 2009
BB2



Georgia Southern Chorale

Conductor: Dr, Shannon Jeffreys
Statesboro, Georgia USA

Founded: 1995
A1, SP



Highland Baptist Church Choir

Conductor: Austin Echols
Louisville, Kentucky USA

Founded: 1893
FSC



Lafayette High School Madrigal Singers

Conductor: Ryan Marsh
Lexington, Kentucky USA

Founded: 1939
G3, FSC



Little Miami Mixed Select Chorus

Conductor: Sarah J. Baker
Morrow, Ohio USA

Founded: 2007
FSC



Little Miami Select Women's Chorale

Conductor: Sarah J. Baker
Morrow, Ohio USA

Founded: 2003
G2, P, FC



Louisville Chamber Choir

Conductor: Dr. Kent Hatteberg
Louisville, Kentucky USA

Founded: 2013
FSC



Melodic Connections

Conductor: Betsey Zenk Nuseibeh
Cincinnati, Ohio USA

Founded: 2009
AL, ALFSC

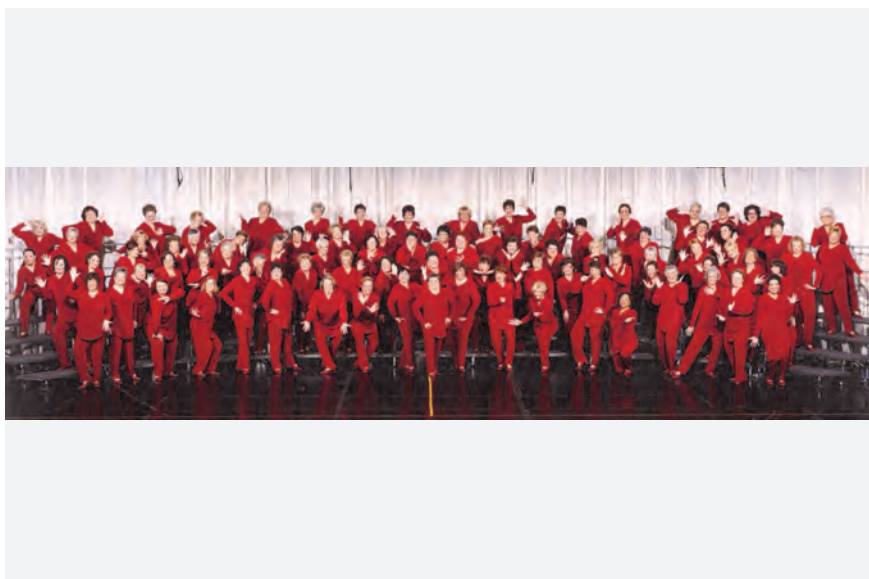

Pride of Kentucky Chorus

Conductor: Debbie Hite
Louisville, Kentucky USA

Founded: 1983
BB1, FC



Seattle Children's Chorus - Arioso

Conductor: Krista Mason
Seattle, Washington USA

Founded: 1989
G2, SP, FC



Sound of Joy Choir

Conductor: Xi Wang
Cincinnati, Ohio USA

Founded: 2006
B3



Thoroughbred Chorus

Conductor: Andrew Wheaton
Louisville, Kentucky USA

Founded: 1945
BB1



To the Nines

Conductor: Terri McCoy
Cincinnati, Ohio USA

Founded: 2011
AL, ALFSC, FC



University of Louisville Collegiate Chorale

Conductor: Dr. Kent Hatteberg
Louisville, Kentucky USA

FSC



Western Hills Advanced Chorale

Conductor: Tiffany Marsh
Frankfort, Kentucky USA

Founded: 1980
G3



Youth Performing Arts School Chamber Choir

Conductor: Jacob Cook
Louisville, Kentucky USA

Founded: 1978
G3, FSC, FC

It's at our House this Year!

Christmas Day Brunch

Open Christmas Day
11am - 5pm

Call for Reservations
502.568.4239 or RVUE.com

25 Stories Up
Atop the Galt House Hotel
140 N. Fourth Street

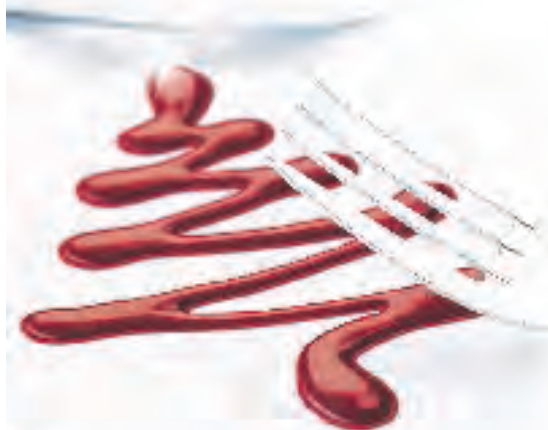

R V U E
RESTAURANT & LOUNGE

25% OFF*
LOUISVILLE MERCHANDISE

LOUISVILLE VISITORS CENTER
201 SOUTH FOURTH STREET

AT THE CORNER OF 4TH & JEFFERSON STREETS

MONDAY - SATURDAY 10A - 5P

SUNDAY 12P - 5P

502.579.6009

*Excludes food & drink items.

Louisville

GoToLouisville.com

SPECIAL THANKS TO OUR
IN-KIND PARTNERS
 FOR THEIR GENEROUS
 SUPPORT OF SERVICES
 AND PRODUCTS



GALT HOUSE HOTEL
The Heart of Louisville



STONEWARE
 est. 1815



THANK YOU!

Singing Together Brings Nations Together!



**INTERNATIONAL CHORAL
FESTIVAL AND COMPETITION**

LOUISVILLE, KENTUCKY USA

REGISTER YOUR CHOIR TODAY!

November 27 - 30, 2014

Presented by
Christmas at the Galt House Hotel



Be part of a festival and competition like no other, drawing choirs from all around the world! *Sing 'n' Joy* is the signature series of INTERKULTUR Choral Events that celebrate the joy of singing together to create unforgettable musical moments. In addition to competition, evaluations and workshops, choirs may sing in Friendship Concerts in beautiful churches, museums, and other venues in the city, or choose to sing in one of the festival stage choir projects. Participating choirs will be able to enjoy the best of Louisville by experiencing its many annual holiday attractions!



Interested choirs should contact:

**KIM MANN
INTERKULTUR AMERICAS
7667 Wooster Pike
Cincinnati, OH 45227 USA
sing@interkulturamericas.com
513-561-7464 (513-561-7664 fax)**

